

SPECIFICATIONS	
OVERALL LENGTH	6" TO 120"
OVERALL WIDTH	5" TO 63"
BETWEEN FRAME RAILS	2" TO 60"
BALL CENTERS	2", 3", 4", 6"
BALL PATTERN	STRAIGHT, OPTIONAL STAGGERED
BALL TRANSFER	1" DIA CARBON STEEL   1/4" - 20 BOLT
SIDE CHANNELS	3 1/2" X 1 1/2" X 10 GA
FRAME MATERIAL	PLAIN STEEL
FINISH	INDUSTRIAL ENAMEL

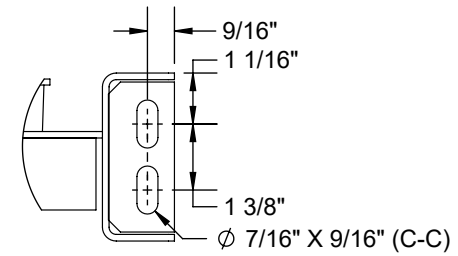

DETAIL A  
BUTT COUPLING  
DIMENSIONS

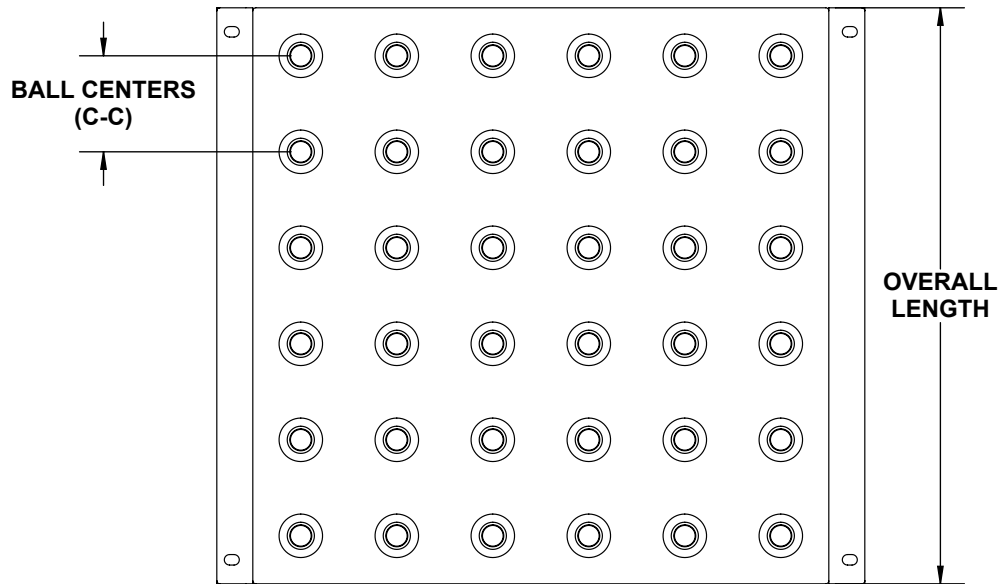
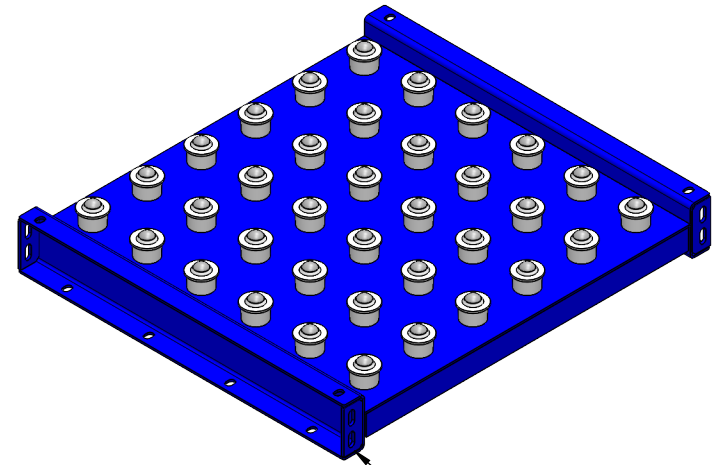
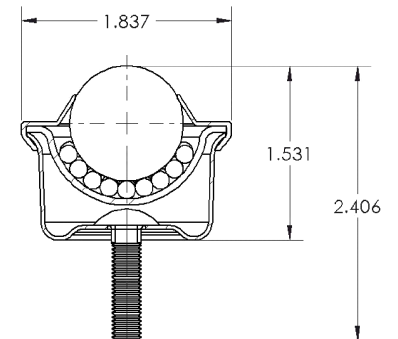
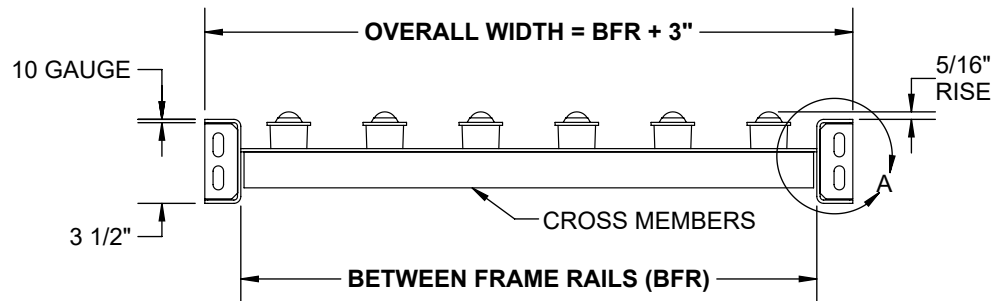

RM-1000  
LUBRICATION TYPE: OIL  
LOAD RATING: 150 LBS.  
TEMP. RATING: UP TO 400F

REV	1.0	<b>Model: BTF - Ball Table Frame Style</b>	
-----	-----	--	--